

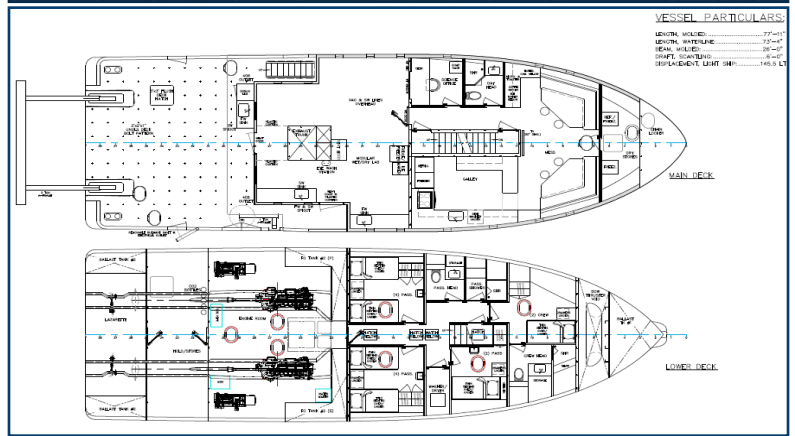

# R/V W.T. Hogarth

[fio.usf.edu/vessel-fleet/rv-w-t-hogarth](http://fio.usf.edu/vessel-fleet/rv-w-t-hogarth)



R/V W.T. Hogarth, FIO's state-of-the-art Research Vessel, is equipped with berths for 10 scientists, wet & dry labs on board, a Satellite Internet Link, Fisheries Eco-Sounders, Dual Head Swath Bathymetry (for bottom-mapping), and a Dynamic Positioning System. Named after FIO's former director, Dr. William Hogarth, the 78-foot, 139-ton vessel contains berthing for 10 people.

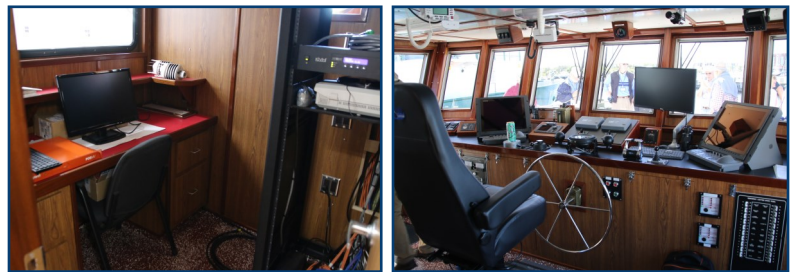

## Specifications:

- Beam: 26 ft (7.92m)
- Draft: 6.5 ft (1.98m)
- Cruising Speed: 10 knots
- Maneuvering Speed: 2 knots
- Cruising Range: 1000 miles (1609 km)
- Endurance: 7 days
- Main Engines: (2) Caterpillar C18 ACERT 600 HP
- Generators: (2) John Deere 55kw, 148 HP @ 1800RPM
- 110 and 208V 3phase, 480V, 24V Electrical System
- Crew Berths: 6, Scientific Berths: 10
- Working Deck Area: 20 feet x 24 feet (480 sq ft)
- Dry Lab: 150 sq. ft; Wet Lab: 120 sq ft.
- Potable Water: 1400 gallons, Water Makers Inc. 1,000 gal/day
- Video wall in science lab (9-monitor display panel)

- Kongsberg K-Pos DP-11 Dynamic Positioning System
- Vaisala WXT520 Meteorological instruments
- AIS equipped (Furuno FA-170)
- Nav: Nobeltec Odyssey software
- Gyro-Compass: Simrad GC80/GC85
- Depth Sounders: Furuno Dual Frequency 1150 3kw, 50khz/200khz
- KVH V7 Mini-VSAT Broadband,
- Applanix Oceanmaster POS-MV
- Multibeam system: Teledyne Reson T50 Dual Head
- Fresh & saltwater in labs and on main deck
- Flowthrough Thermosalinograph
- Aft Main Winch, CTD Winch, Hydro Winch (Interocean Systems)
- Main winch: 3/8", 7x19 wire rope
- Aft A-frame: 12'W x 12'H, SWL: 6,000 lbs.
- Side J-Frame (starboard): 5'W x 12'H, 1/4" wire rope

**78-foot (24 meter) Research Vessel**

**Includes:**

- Fuel for 24/7 operation
- Meals (minimum of 3/day including snacks)
- Lubricants and various supplies as needed (listed below)
- Insurance coverage
- Crew assistance- loading/unloading equipment
- Crew of 4 (up to 6 as necessary)

No additional cost

- Marine Technician, 24/7 coverage

\$1200/day

- Mobilization/Demobilization (additional charge applied if loading/unloading takes more than 2 hours and requires FIO crew)

No charge/1st day  
\$1,800/ per add'l day

- Transit Day(s)

\$6,700/day

**On-Board Equipment:**

- SBE 25/32 CTD/Carousel System with 12, 5-liter Teflon lined water sampler bottles
- CTD Winch: 1000 meters 322 electro-mechanical wire, SWL: 1500 lbs.
- Hydro Winch, capacity 1000 meters, SWL: 1500 lbs.
- Kongsberg EK80 Echosounder w/ 38, 70, 120, 200khz transducers
- Teledyne Workhorse Mariner 1200 kHz ADCP
- Semi-rigid inflatable. 14.5 foot, 60 HP Honda O/B

**Available by request:**

- VideoRay Pro-3 ROV (depth capable of 100m)
- 13' Boston Whaler
- 30-foot otter trawls
- Plankton nets
- Nueston net frame
- Various sediment grabs
- Capetown dredge
- Secchi Disk
- Refractometer
- Aquaria with air pumps

No additional cost

**Additional Equipment Available:**

- Multibeam mapping, dual head Teledyne/RESON w/ POS-MV\*
- VideoRay Defender ROV (depth capable of 300m)\*
- Scuba Tanks
- 25-foot dive boat (R/V Price)\*\*

- \$400 for mob/de-mob
- \$250/day
- \$7/cylinder, \$5/air fill
- \$300/day + Fuel

\*= requires Marine Technician

\*\*= requires Captain